



PRESTIGE

FINSBURY
PARK-REGENT

A LIVING EXPERIENCE LIKE NO OTHER

B A G A L U R

Aerial View



Artist's Impression



Write your own story to an unmatched living experience.

A wonderful enclave of exclusive homes. The perfect address for those who wish to beat the daily commute to work and yet be insulated from the bustle of urban life.

Prestige Finsbury Park is a township destination of 25 acres situated adjacent to the aerotropolis within the IT/Aerospace and Hardware Park. This park is being developed by the KIADB which will be the hub in the future for the IT and Aerospace sectors, the park also has a limited allotment for residential developments within which Prestige Finsbury Park is located. Well reputed schools and colleges, healthcare facilities, as well as shopping and entertainment hubs, are all within easy reach.

Prestige Finsbury Park consists of two developments – Prestige Finsbury Park - Hyde, spread over 15 acres, and Prestige Finsbury Park - Regent, spanning 10 acres. They are independent developments located beside each other and each has its own identity, approvals, amenities and facilities.

Prestige Finsbury Park- Regent comprises aesthetically designed three bedroom homes in 6 towers which rise up to 20 floors, and consists of 958 apartments, so you can choose the one that best suits your needs. These smartly designed homes are naturally well-lit and situated in towers overlooking the lush green open landscape.

Enjoy the luxury of a fully equipped clubhouse with a gamut of recreational amenities including a swimming pool, gym, health club, indoor badminton court, party halls, billiards, table tennis, board games, reading room, and provision for a crèche. There is also provision for a convenience store, pharmacy and doctor's clinic, a mini theatre and space for an ATM.

The open landscape also has an outdoor games area, and elders' park, a children's play area and a pet park.

All ensuring that every need of the neighborhood is met.

Go ahead, turn the page and explore your home at Prestige Finsbury Park - Regent.

Discover a quality of life that is truly unique.

PRM/KA/RERA/1251/472/PR/191206/003056

Master Plan - Regent



Numbering Plan - Regent

3 BED UNITS		SALEABLE AREA		CARPET AREA	
Unit type	No. of Bed	(sqm)	(sqft)	(sqm)	(sqft)
C 1	3 BED (2 T)	113.73	1224	79.02	851
C 2	3 BED (2 T)	113.73	1224	79.19	852
C 3	3 BED (2 T)	113.73	1224	79.19	852
C 4	3 BED (2 T)	114.52	1233	79.22	853
C 5	3 BED (2 T)	118.69	1277	81.61	878
C 6	3 BED (2 T)	118.69	1277	81.61	878
C 7	3 BED (3 T)	132.92	1431	93.13	1002
C 8	3 BED (3 T)	132.92	1431	93.13	1002
C 9	3 BED (3 T)	134.32	1445	94.85	1021
C 10	3 BED (3 T)	136.81	1473	97.05	1045
C 11	3 BED (3 T)	136.81	1473	97.05	1045
C 12	3 BED (3 T)	136.81	1473	97.05	1045
C 13	3 BED (3 T)	136.81	1473	97.05	1045
C 14	3 BED (3 T)	136.81	1473	97.05	1045
C 15	3 BED (3 T)	144.11	1552	99.87	1075
C 16	3 BED (3 T)	145.06	1562	98.85	1064
C 17	3 BED (3 T)	145.06	1562	98.85	1064



Cluster Plan - Building 1A Tower - 13



BUILDING - 1A		TOWER-13	SALEABLE AREA		CARPET AREA	
COLOUR	Unit type	No. of Bed	(sqm)	(sft)	(sqm)	(sft)
1	C 6	3 BED	118.69	1,277	81.61	878
2	C 6	3 BED	118.69	1,277	81.61	878
3	C 1	3 BED	113.73	1,224	79.02	851
4	C 2	3 BED	113.73	1,224	79.19	852
5	C 8	3 BED	132.92	1,431	93.13	1,002
6	C 8	3 BED	132.92	1,431	93.13	1,002
7	C 17	3 BED	145.06	1,562	98.85	1,064
8	C 13	3 BED	136.81	1,473	97.05	1,045

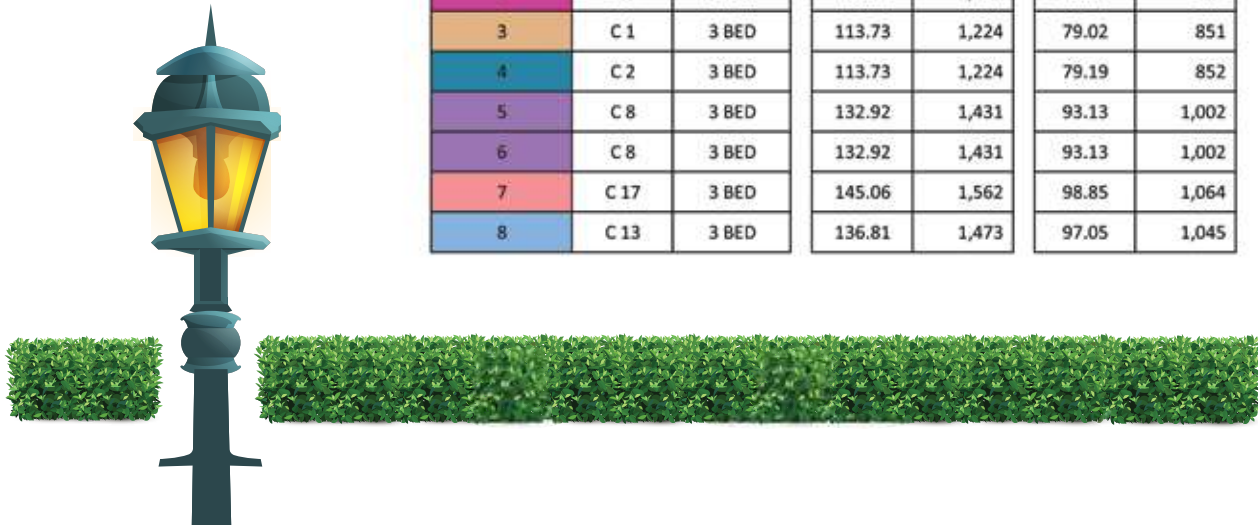

Cluster Plan - Building 1A Tower - 14

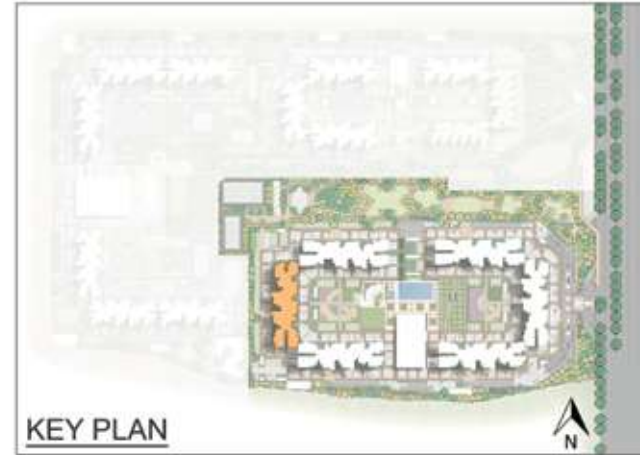
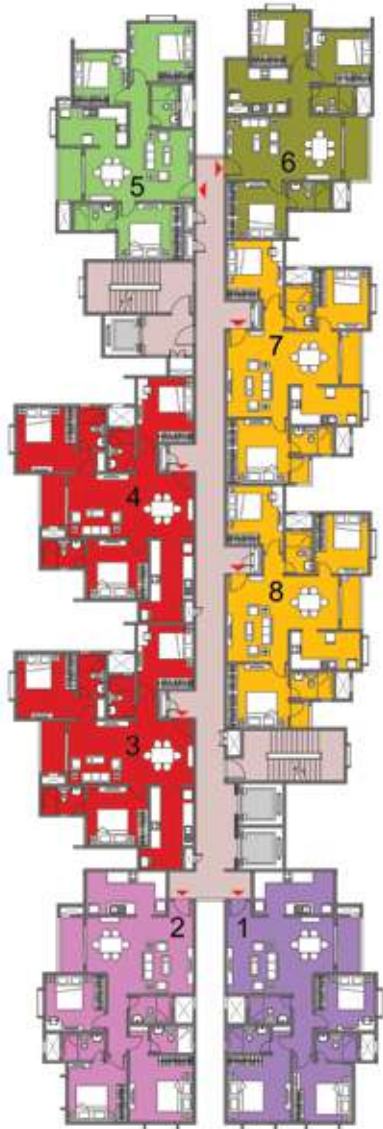

BUILDING - 1A		TOWER-14	SALEABLE AREA		CARPET AREA	
COLOUR	Unit type	No. of Bed	(sqm)	(sft)	(sqm)	(sft)
1	C 12	3 BED	136.81	1,473	97.05	1,045
2	C 14	3 BED	136.81	1,473	97.05	1,045
3	C 7	3 BED	132.92	1,431	93.13	1,002
4	C 7	3 BED	132.92	1,431	93.13	1,002
5	C 3	3 BED	113.73	1,224	79.19	852
6	C 4	3 BED	114.52	1,233	79.22	853
7	C 5	3 BED	118.69	1,277	81.61	878
8	C 5	3 BED	118.69	1,277	81.61	878



Cluster Plan - Building 1A Tower - 15



BUILDING - 1A			TOWER-15		SALEABLE AREA		CARPET AREA	
COLOUR	Unit type	No. of Bed	(sqm)	(sft)	(sqm)	(sft)	(sqm)	(sft)
1	C 17	3 BED	145.06	1,562	98.85	1,064		
2	C 16	3 BED	145.06	1,562	98.85	1,064		
3	C 6	3 BED	118.69	1,277	81.61	878		
4	C 6	3 BED	118.69	1,277	81.61	878		
5	C 9	3 BED	134.32	1,445	94.85	1,021		
6	C 15	3 BED	144.11	1,552	99.87	1,075		
7	C 8	3 BED	132.92	1,431	93.13	1,002		
8	C 8	3 BED	132.92	1,431	93.13	1,002		

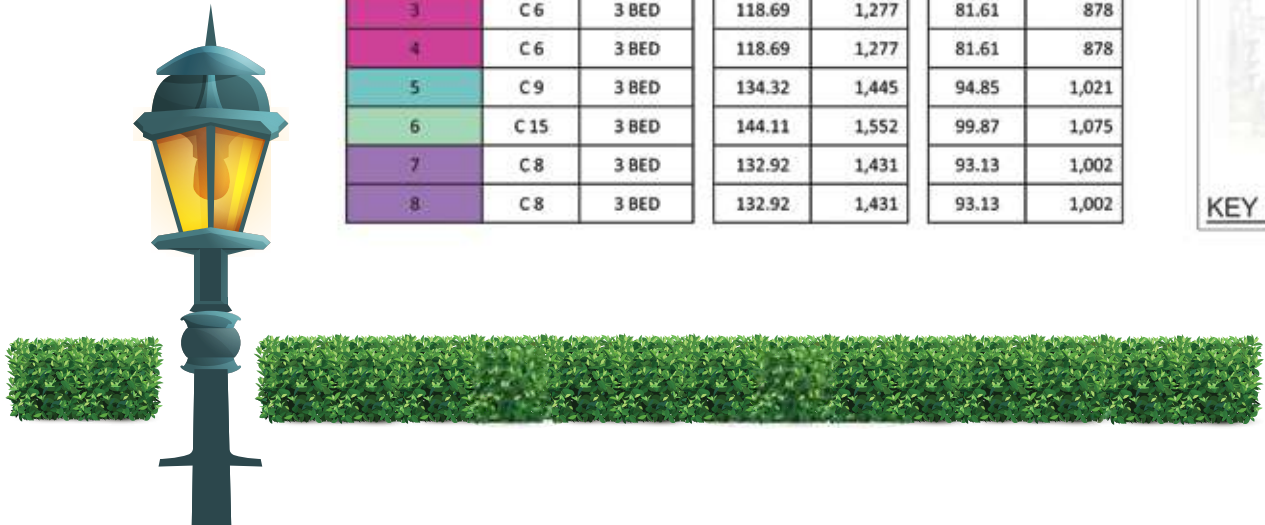

Cluster Plan - Building 1B Tower - 16

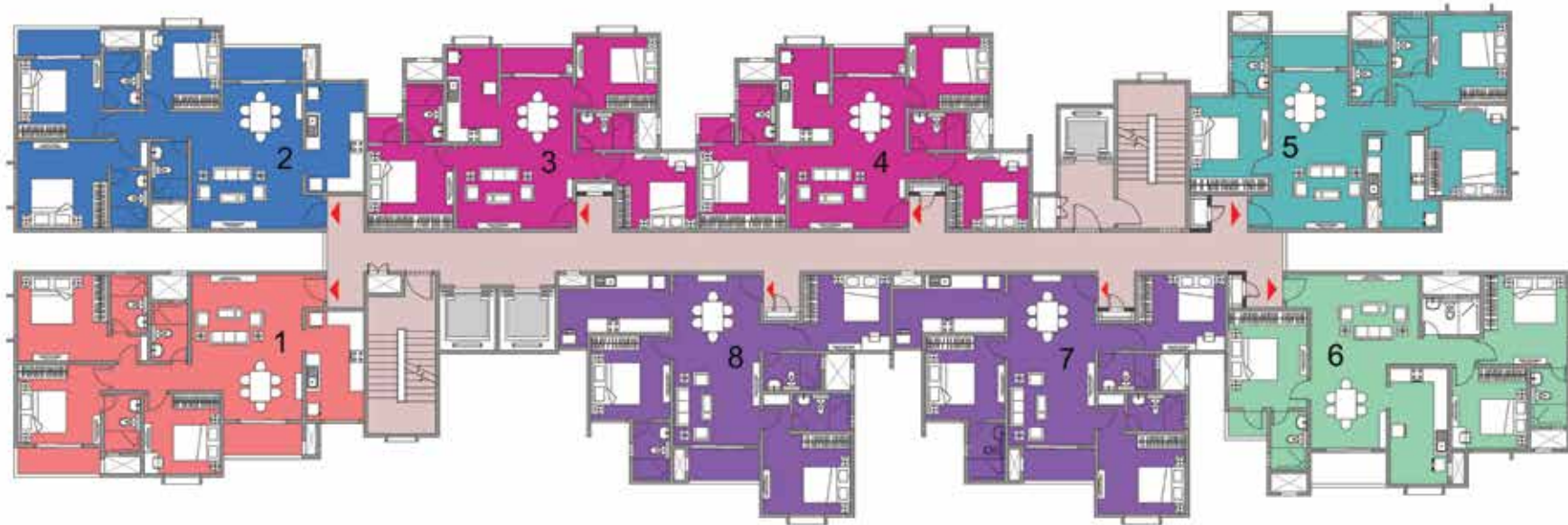

BUILDING - 1B			TOWER-16		SALEABLE AREA		CARPET AREA	
COLOUR	Unit type	No. of Bed	(sqm)	(sft)	(sqm)	(sft)	(sqm)	(sft)
1	C 17	3 BED	145.06	1,562	98.85	1,064		
2	C 16	3 BED	145.06	1,562	98.85	1,064		
3	C 6	3 BED	118.69	1,277	81.61	878		
4	C 6	3 BED	118.69	1,277	81.61	878		
5	C 9	3 BED	134.32	1,445	94.85	1,021		
6	C 15	3 BED	144.11	1,552	99.87	1,075		
7	C 8	3 BED	132.92	1,431	93.13	1,002		
8	C 8	3 BED	132.92	1,431	93.13	1,002		



Cluster Plan - Building 1B Tower - 17

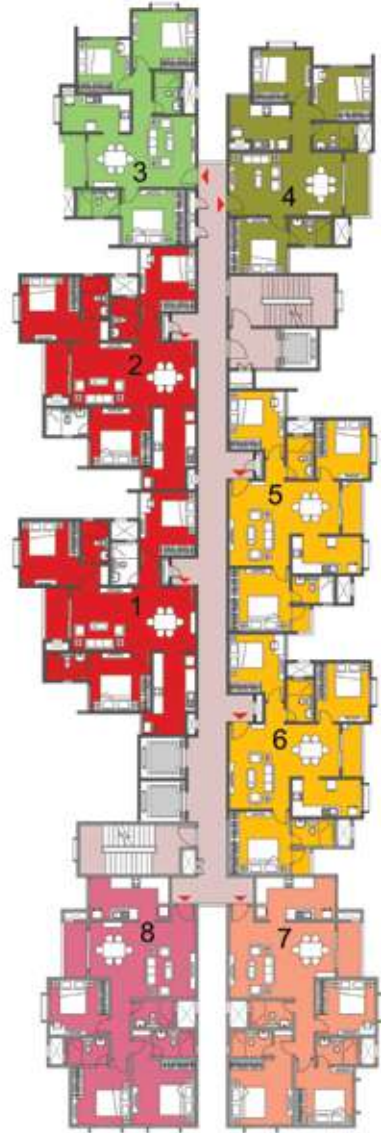

BUILDING - 1B		TOWER-17	SALEABLE AREA		CARPET AREA	
COLOUR	Unit type	No. of Bed	(sqm)	(sft)	(sqm)	(sft)
1	C 7	3 BED	132.92	1,431	93.13	1,002
2	C 7	3 BED	132.92	1,431	93.13	1,002
3	C 3	3 BED	113.73	1,224	79.19	852
4	C 4	3 BED	114.52	1,233	79.22	853
5	C 5	3 BED	118.69	1,277	81.61	878
6	C 5	3 BED	118.69	1,277	81.61	878
7	C 11	3 BED	136.81	1,473	97.05	1,045
8	C 10	3 BED	136.81	1,473	97.05	1,045



Cluster Plan - Building 1B Tower - 18



BUILDING - 1B		TOWER-18	SALEABLE AREA		CARPET AREA	
COLOUR	Unit type	No. of Bed	(sqm)	(sft)	(sqm)	(sft)
1	C 6	3 BED	118.69	1,277	81.61	878
2	C 6	3 BED	118.69	1,277	81.61	878
3	C 1	3 BED	113.73	1,224	79.02	851
4	C 2	3 BED	113.73	1,224	79.19	852
5	C 8	3 BED	132.92	1,431	93.13	1,002
6	C 8	3 BED	132.92	1,431	93.13	1,002
7	C 17	3 BED	145.06	1,562	98.85	1,064
8	C 16	3 BED	145.06	1,562	98.85	1,064



Exterior View - North East



Unit Type - C1

3 Bed Classic

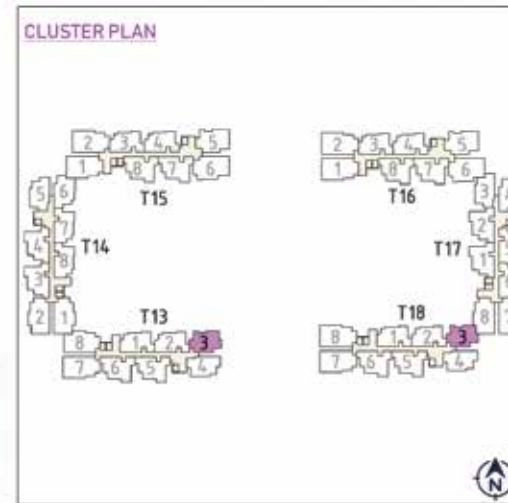

Building-1A & 1B

Tower 13, Unit 3 - Ground To 20th Floor
 Tower 18, Unit 3 - Ground To 20th Floor

TYPE - C1 (3 BED)

SALE AREA	1224 Sft	113.73 Sqm
CARPET AREA	851 Sft	79.02 Sqm



Unit Type - C2

3 Bed Classic

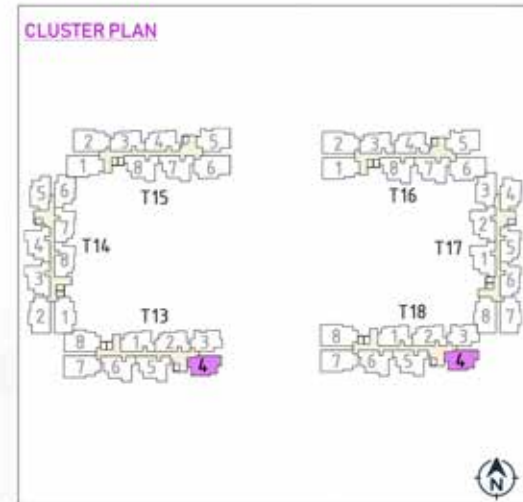
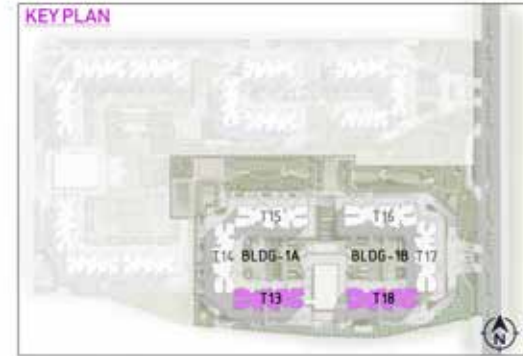

Building-1A & 1B

Tower 13 & 18,
Unit 4 - Ground To 18th & 20th Floor

TYPE - C2 (3 BED)

SALE AREA	1224 Sft	113.73 Sqm
CARPET AREA	852 Sft	79.19 Sqm



Unit Type - C3

3 Bed Classic

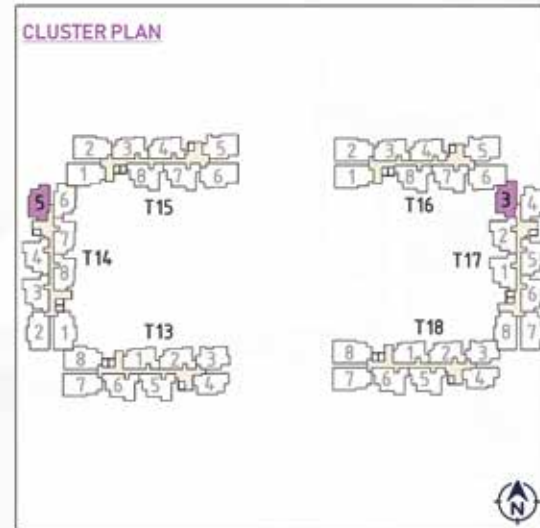
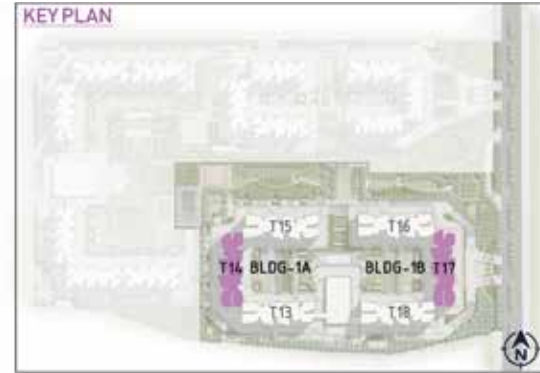

Building-1B

Tower 14, Unit 5 - Ground To 18th Floor
 Tower 17, Unit 3 - Ground To 19th Floor

TYPE - C3 (3 BED)

SALE AREA	1224 Sft	113.73 Sqm
CARPET AREA	852 Sft	79.19 Sqm



Unit Type - C4

3 Bed Classic

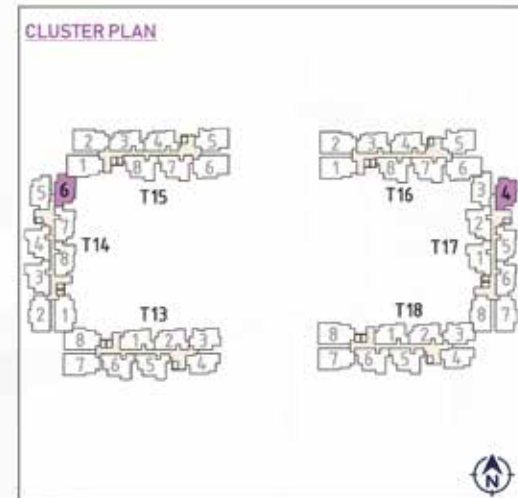

Building-1A & 1B

Tower 14, Unit 6 - Ground To 19th Floor

Tower 17, Unit 4 - Ground To 18th Floor

TYPE - C4 (3 BED)

SALE AREA	1233 Sft	114.52 Sqm
CARPET AREA	853 Sft	79.22 Sqm



Unit Type - C5

3 Bed Classic

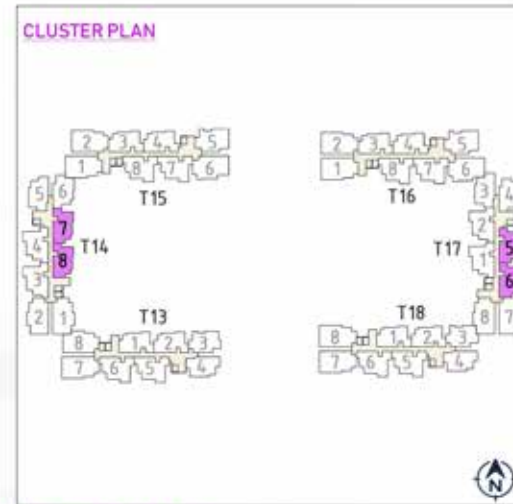
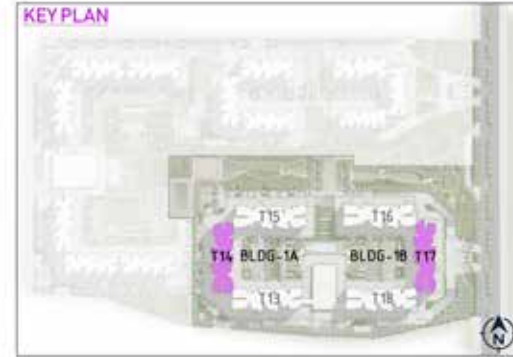

Building-1A & 1B

- Tower 14, Unit 7 - Ground To 19th Floor
- Unit 8 - 1st To 19th Floor
- Tower 17, Unit 5 - Ground To 18th Floor
- Unit 6 - 2nd To 19th Floor

TYPE - C5 (3 BED)

SALE AREA	1277 Sft	118.69 Sqm
CARPET AREA	878 Sft	81.61 Sqm



Lobby View



Unit Type - C7

3 Bed Premium

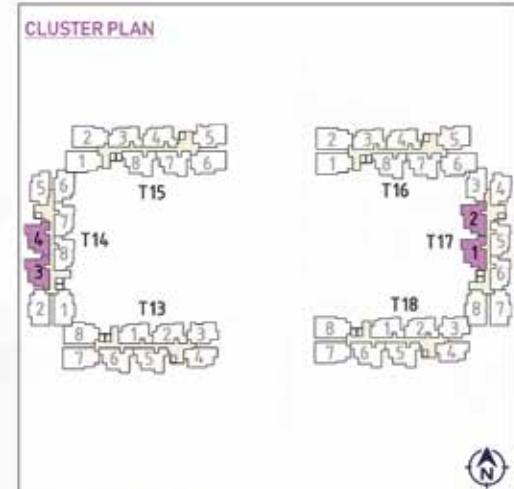
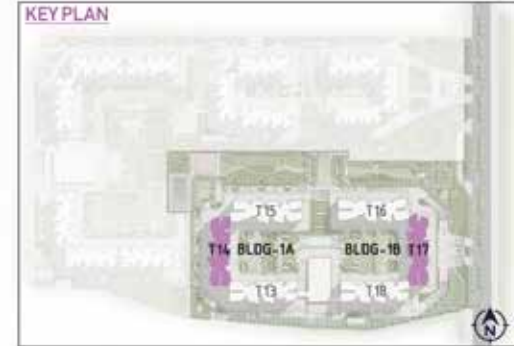

Building-1A & 1B

- Tower 14, Unit 3 - 2nd To 19th Floor
- Unit 4 - Ground To 18th Floor
- Tower 17, Unit 1 - 1st To 19th Floor
- Unit 2 - Ground To 19th Floor

TYPE - C7 (3 BED)

SALE AREA	1431 Sft	132.92 Sqm
CARPET AREA	1002 Sft	93.13 Sqm



Unit Type - C8

3 Bed Premium

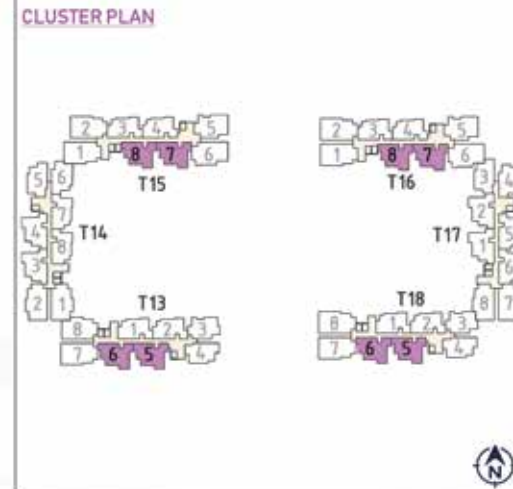
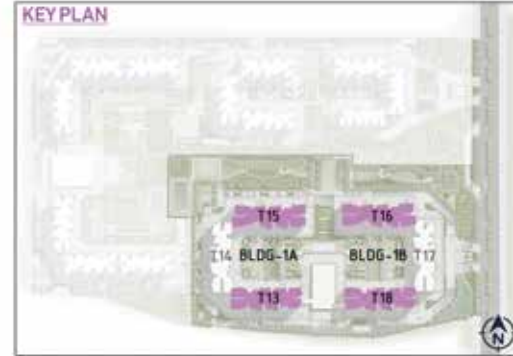

Building-1A & 1B

- Tower 13 & 18, Unit 5 - Ground To 18th & 20th Floor
- Unit 6 - 2nd To 20th Floor
- Tower 15 & 16, Unit 7 - Ground To 19th Floor
- Unit 8 - 1st To 19th Floor

TYPE - C8 (3 BED)

SALE AREA	1431 Sft	132.92 Sqm
CARPET AREA	1002 Sft	93.13 Sqm



Unit Type - C9

3 Bed Premium

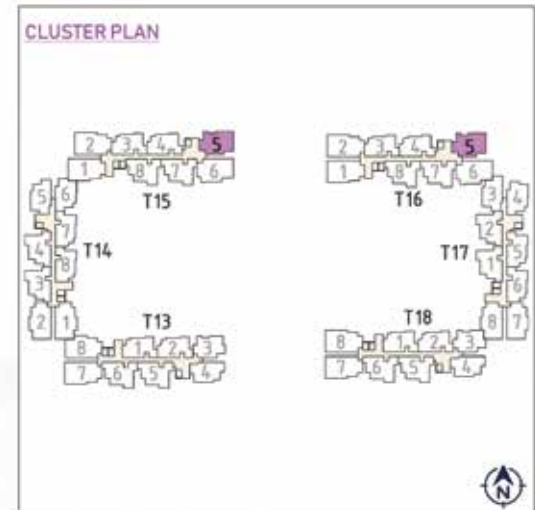
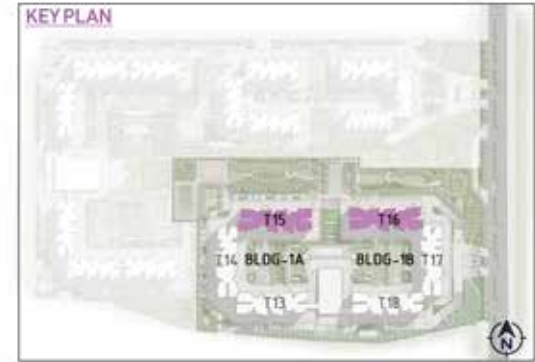

Building-1A, 1B

Tower 15 & 16, Unit 5 - Ground To 18th Floor

TYPE - C9 (3 BED)

SALE AREA	1445 Sft	134.32 Sqm
CARPET AREA	1021 Sft	94.85 Sqm



Unit Type - C10

3 Bed Premium

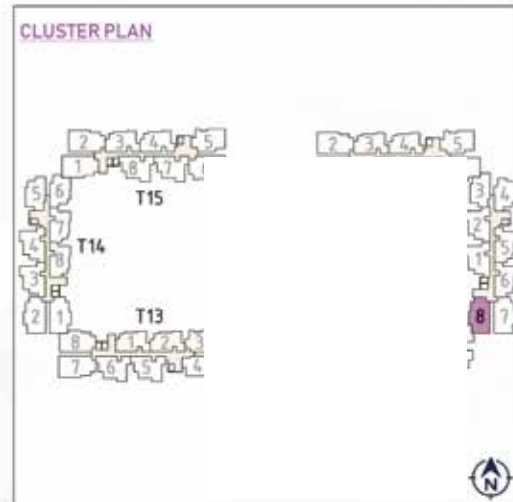

Building-1B
Tower 17, Unit 8 - Ground To 19th Floor

TYPE - C10 (3 BED)

SALE AREA	1473 Sft	136.81 Sqm
CARPET AREA	1045 Sft	97.05 Sqm



Unit Type - C11

3 Bed Premium

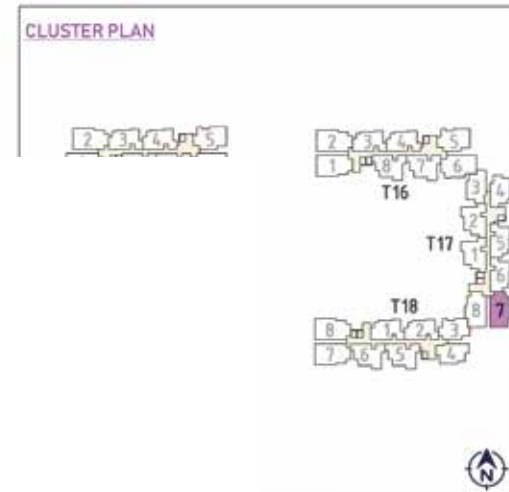
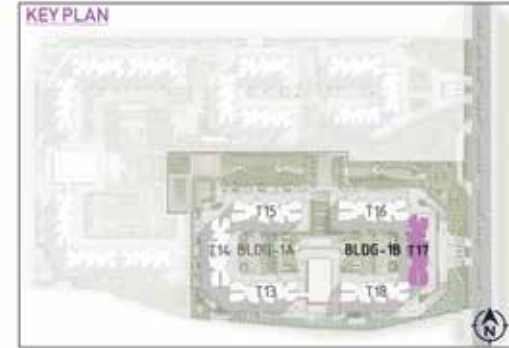

Building-1B
Tower 17, Unit 7 - Ground To 19th Floor

TYPE - C11 (3 BED)

SALE AREA	1473 Sft	136.81 Sqm
CARPET AREA	1045 Sft	97.05 Sqm



Unit Type - C12

3 Bed Premium

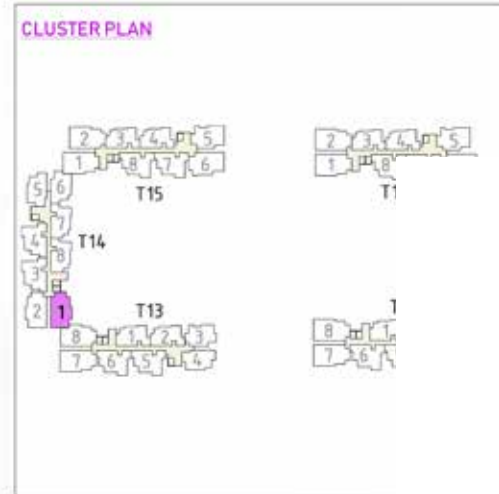
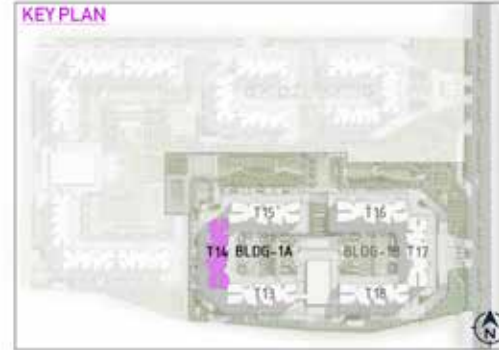

Building-1A

Tower 14, Unit 1 - Ground To 19th Floor

TYPE - C12 (3 BED)

SALE AREA	1473 Sft	136.81 Sqm
CARPET AREA	1045 Sft	97.05 Sqm



Unit Type - C13

3 Bed Premium

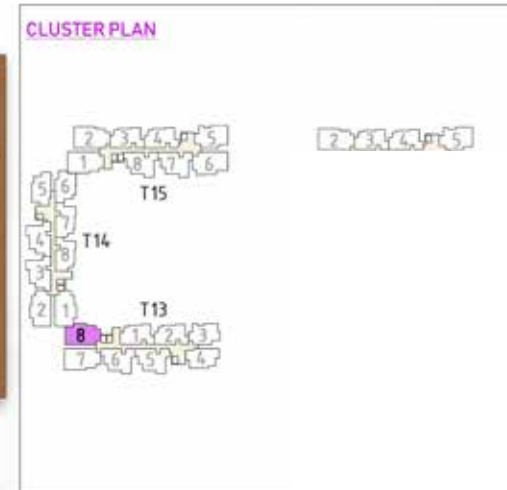
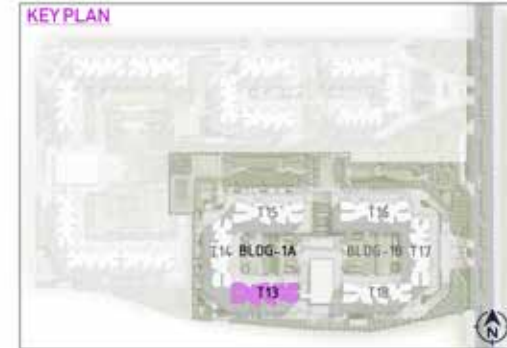

Building-1A
Tower 13, Unit 8 - Ground To 20th Floor

TYPE - C13 (3 BED)

SALE AREA	1473 Sft	136.81 Sqm
CARPET AREA	1045 Sft	97.05 Sqm



Unit Type - C14

3 Bed Premium

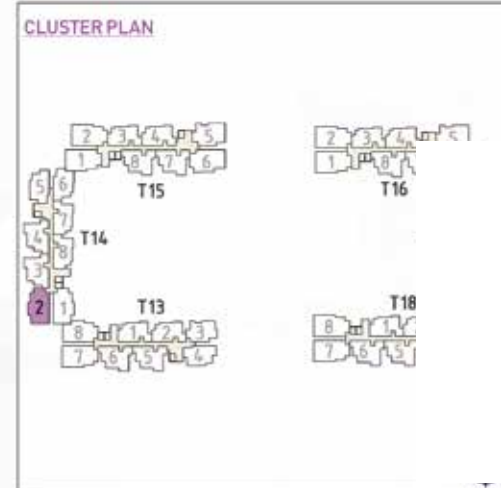
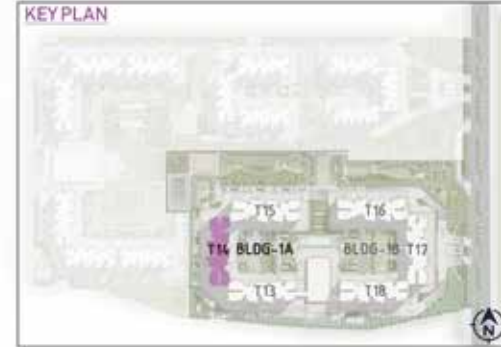

Building-1A
Tower 14, Unit 2 - Ground To 19th Floor

TYPE - C14 (3 BED)

SALE	1473 Sft	136.81 Sqm
CARPET	1045 Sft	97.05 Sqm



Unit Type - C15

3 Bed Premium

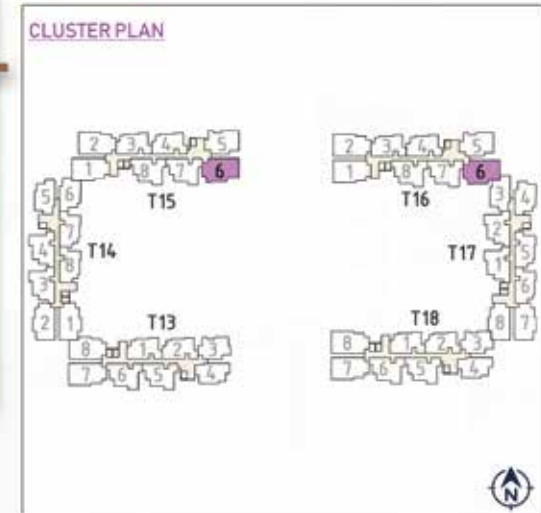

Building-1A & 1B

Tower 15 & 16, Unit 6 - Ground To 19th Floor

TYPE - C15 (3 BED)

SALE AREA	1552 Sft	144.11 Sqm
CARPET AREA	1075 Sft	99.87 Sqm



Unit Type - C16

3 Bed Premium

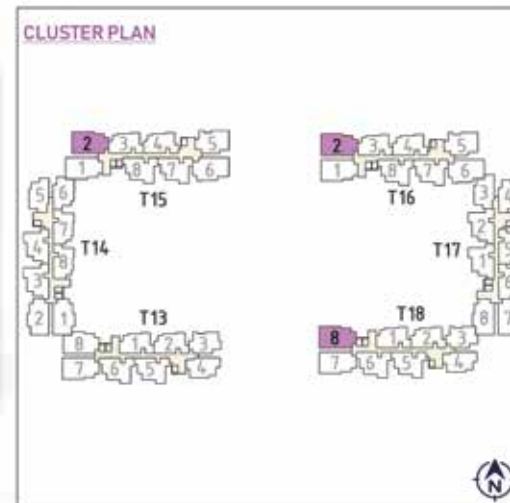
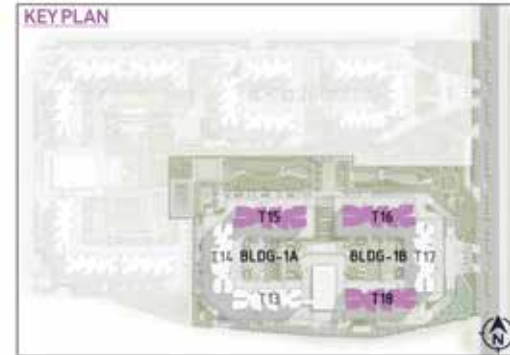

Building-1A & 1B

Tower 15 & 16, Unit 2 - Ground To 19th Floor
 Tower 18, Unit 8 - Ground To 20th Floor

TYPE - C16 (3 BED)

SALE AREA	1562 Sft	145.06 Sqm
CARPET AREA	1064 Sft	98.85 Sqm



Unit Type - C17

3 Bed Premium

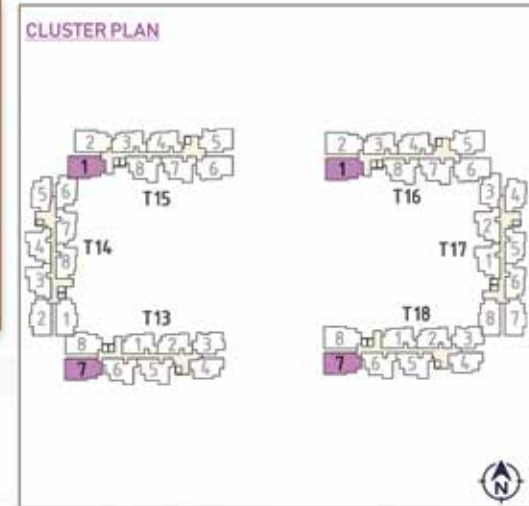
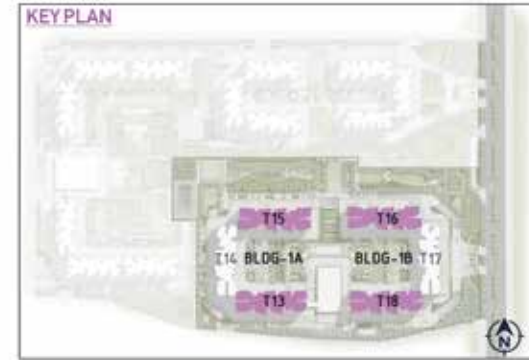

Building-1A & 1B

Tower 15 & 16, Unit 1 - Ground To 19th Floor
 Tower 13 & 18, Unit 7 - Ground To 20th Floor

TYPE - C17 (3 BED)

SALE AREA	1562 Sft	145.06 Sqm
CARPET AREA	1064 Sft	98.85 Sqm



Clubhouse



Artist's Impression



Clubhouse



Location Map

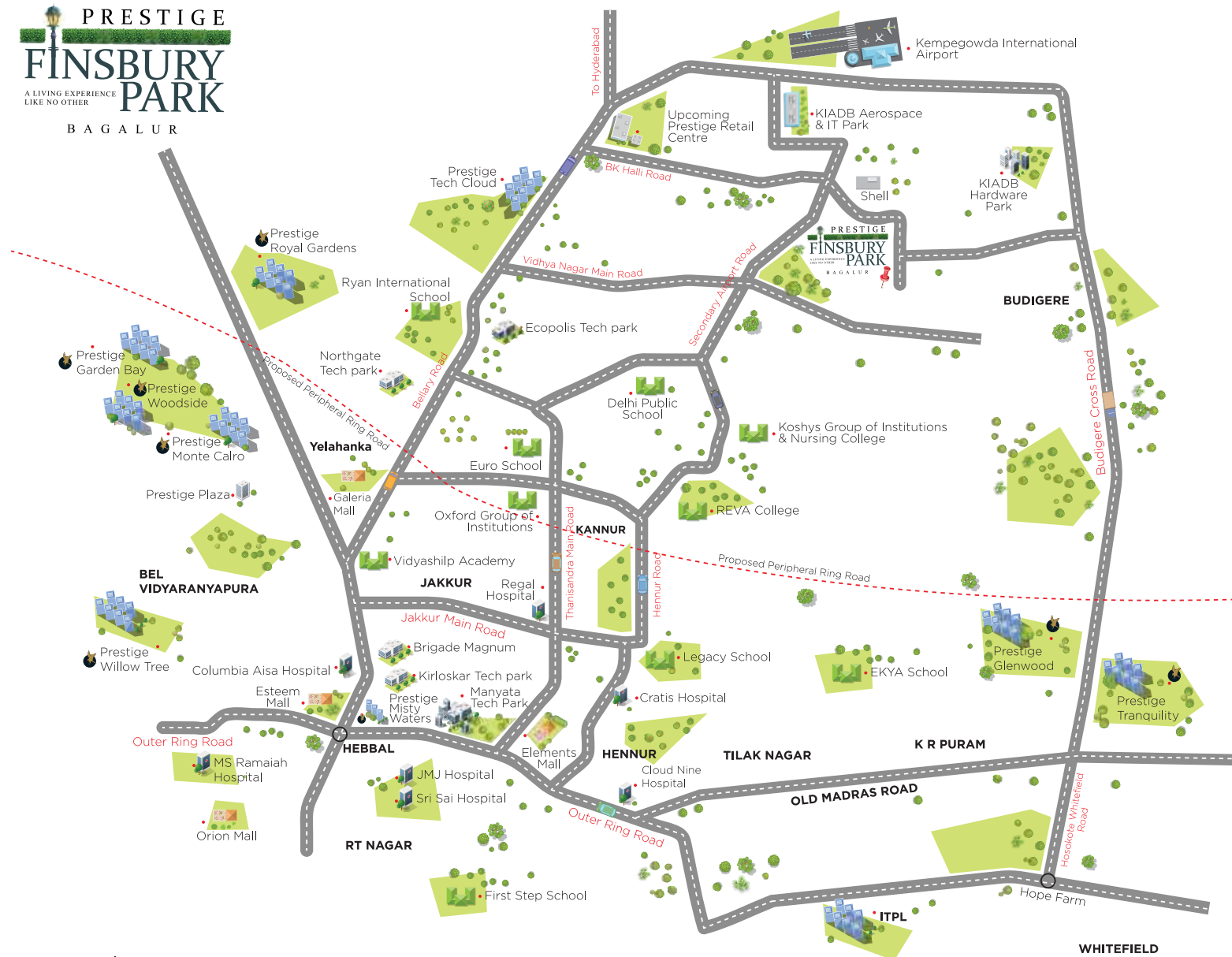

Map not to scale

Pouch



Prestige Estates Projects Ltd.
Prestige Falcon Towers, 19, Brunton Road,
Bengaluru, Karnataka 560025, India
Ph: +91-80-25591080. Fax: +91-80-25591945. E-mail: properties@prestigeconstructions.com

www.prestigeconstructions.com

Marketing Office:
Prestige Finsbury Park
Sy No 45/1, Bagalur Road, Gummanahalli,
Mahadeva Kodigehalli, Bengaluru, Karnataka 562149



• Bengaluru • Chennai • Goa • Hyderabad • Kochi • Mangaluru • Mysuru

Like us on Facebook • Follow Us on Twitter • Make sure you visit The Falcon Blog for the latest at Prestige.

This brochure is conceptual and has been prepared based on the inputs provided by the Project Architect, this may vary during execution, the Promoter reserves the right to change, alter, add or delete any of the specifications mentioned herein based on site conditions and construction exigencies without prior permission or notice. The external color schemes and detailing of landscape may vary as may be suggested by the Architect considering the site conditions. The furniture shown in the plans is only for the purpose of illustrating a possible layout and does not form a part of the offering or specifications.

All Apartment interior views do not depict the standard wall, color & ceiling finishes which are not part of the offering. Further, the dimensions mentioned do not consider the plastering thickness and there could be marginal variation in carpet areas..